



VLB-92

13NM - 22NM @ 0.74T

The VLB-92 is state-of-the-art long range LED beacon. It is intended for applications requiring very high intensity.

Depending on the configuration, the beacon is able to produce a range from 13 - 22NM at a transmissivity of 0.74T.

- **Effective intensity settings**
(5 800 - 240 000cd)
- **Day/night transition level settings**
(40-250 lux range)
- **Programmable flash characters, including IALA recommended characters**
- **Programmable custom character**
- **Synchronisation control including master/slave options and sync delay**
- **Synchronising delay can be set**
from 0 to 9.9 seconds
- **Low voltage cut-out setting**
- **Optional security code**

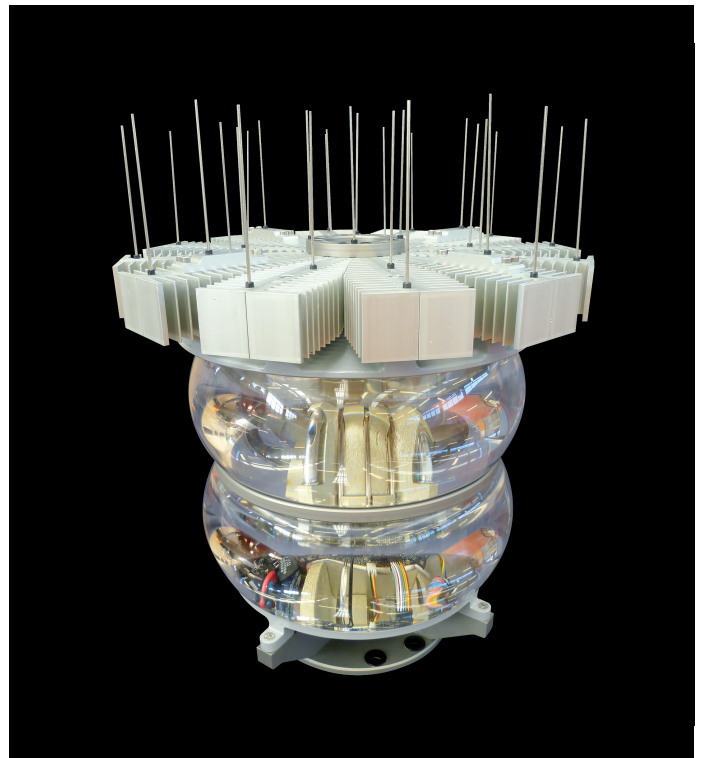

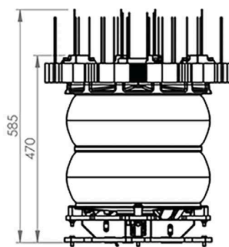
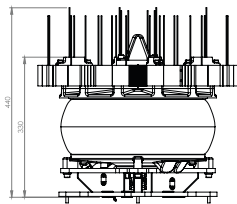
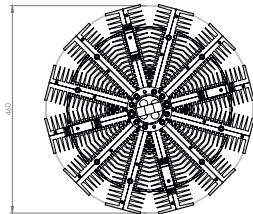

2 TIER
NET MASS: APPROX 38 KG

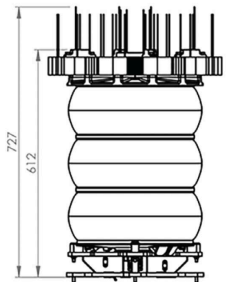

3 TIER
NET MASS: APPROX 47 KG

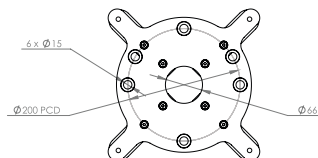

Optical Performance

Maximum intensity / layer	80 000cd
---------------------------	----------

Optical specification

Light source	High Power Light Emitting Diode (LED)
Vertical divergence	±1.6° @ 10% peak ±0.8° @ 50% peak
Temperature control	LEDs monitored for constant intensity control and over temperature protection

Main Technical Specification

Nominal Range	Up to 22 NM
Lens	Machined cast acrylic
Base	2 part painted cast marine grade aluminium
Body	Anodised marine grade aluminium
Designed service life	10 years
Weight	1-tier 31.8kg 2-tier 38kg 3-tier 47kg
Flash character	246 standard characters plus 1 custom character; 20 factory set custom characters
Temperature range	-30° to +50°C / 22° to +122°F
Voltage	24 VDC (20 - 36 VDC)
Solar charger	N/A
Degree of protection	IP67
Cable length	2 m / 6 m

Order Overview VLB-92

Product code

Code	Note
VLB-92-W-1.6-24-Y	
Y	Tiers (1 T, 2 T, 3 T)

Option matrix

VSU-29	Optional integrated GPS synchronization using the VSU-29 GPS Sync Unit. VSU-29 requires 12 V operating voltage.
REMOTE-02	Infrared remote